

## INSTALLATION WARNINGS:

### BEFORE COMMENCING INSTALLATION ISOLATE YOUR MAINS ELECTRIC SUPPLY

Read the instructions care fully before starting the installation process and keep them for future reference. This product must be installed by a qualified electrician. This product should be installed in accordance with the relevant sections of the building regulations code, and the current edition of the IEE Wiring Regulations (BS 7671:Requirements for electrical installations) and appropriate statutory regulations.

Do not exceed the Maximum Power Rating detailed in the specification over leaf.

## Installation

**Remove the glass panel** of a touch remote switch: Using a small flat screwdriver remove the front cover by placing the screw driver in the location notch on the bottom part of the cover and twist to unclip the cover.

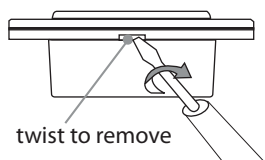

**Wiring:** Wire as described in the diagram overleaf. Push wires firmly into terminals and tighten terminal screws so that wires are held securely. No bare wires should protrude from the terminals. Ensure correct wires are connect to the correct terminals, if incorrectly wired, this could damage the switch.

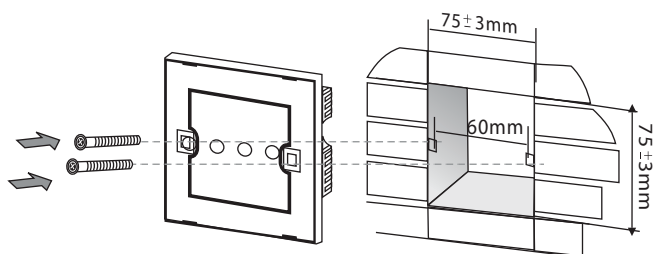

**Fix screws:** Use the screws supplied to attach switch to backbox using a flat head screwdriver

**Reattach the glass panel:** Align the glass panel over the switch and firmly push to click into place.

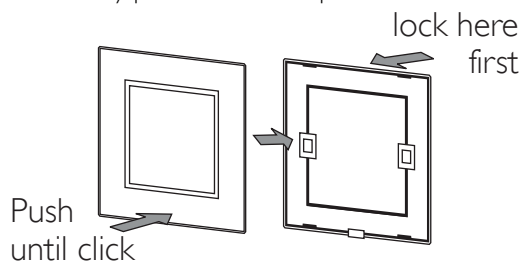

**Power on:** Once the power is on, wait 2 minutes for the switch to power up, then touch the panel to turn on the light.

## The remote (RTS2020 & RTS2040 models only)

### Pairing a remote

1. Touch & hold the active touch area of the switch for 5 seconds and wait for the beep.
2. Press and hold a button (A, B or C) on the remote control and release after you hear a beep.

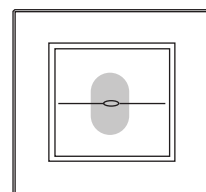

Once paired the paired button will only control the paired gang. The Square button will turn off all lighted paired to the remote.

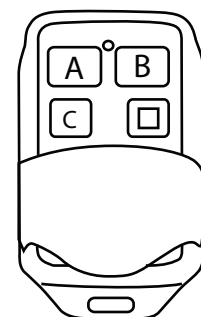

Up to four remote controls can be paired with a single switch. If maximum remotes registered is reached you will hear three beeps.

### Un-registering a remote:

Repeat steps for registering the remote. When pressing and holding the remote button, wait for two beeps and the remote will be un-paired.

**Factory reset:** Press and hold the switch for 5 seconds till you hear a beep, continue to hold for a further 8 seconds until you hear another beep. The switch is now back to factory settings.

**Optional scene remote** available, Can control up to 19 gangs and set up to 6 scenes.

# retrotouch

## INSTRUCTION MANUAL

**RTS2010**  
**RTS2020**  
**RTS2040**

### Using the switch

#### TO TURN ON

Touch the switch panel around the oval to turn on

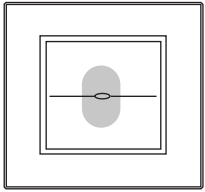

#### TO TURN OFF

Touch the switch panel around the oval to turn off

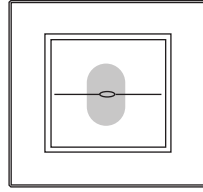

#### USING THE REMOTE

Press A, light turns on, press A again the light turns off

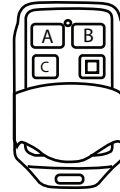

A = 1 gang  
B = 2 gang  
C = 3 gang  
□ = All off

### Wiring diagrams

#### 1 Gang model

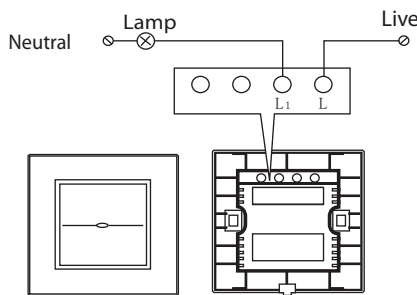

#### 2 Gang model

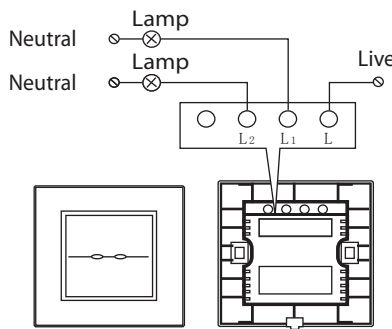

#### 3 Gang model

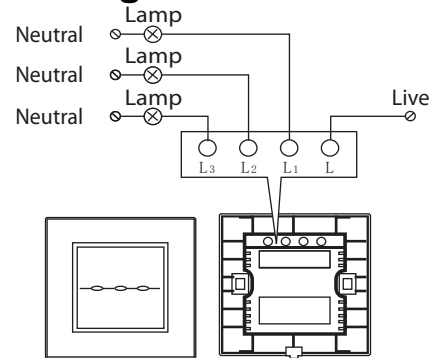

### Specification

Voltage: 220~240V ~ 50/60Hz

Operating Power:

1 Gang (7-800W),  
2 Gang (7-1500W),  
3 Gang (7-1800W),

Working Temperature: 0oC~40oC Relative  
Humidity: 10% - 93%  
Energy Consumption: <0.02W

Measurement: 86x86mm  
Backbox depth: 35mm

life: 100,000 times at least (relay useful life)

Remote usage distance >20M  
Remote battery: 27A 12vDC  
Battery life : 1 year (dependent on usage)  
Power: < 0.1mW

CE & RoHS Certified

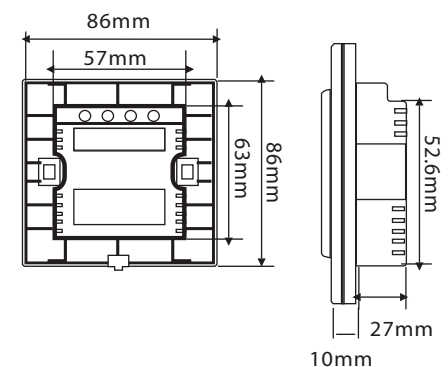

### Guarantee

All items purchased, come with a 1 year warranty (from date of purchase). Please keep proof of purchase.

If any of our products become faulty within this 1 year period, please contact us. Please send product/s by recorded post, as proof of dispatch as we cannot be held liable for products lost in the post. If the product is found to be faulty, a replacement shall be sent within 7 working days from date received. In all cases, an identical replacement shall be sent, however, if the product has been discontinued a suitable alternative shall be sent with the same or similar specification.

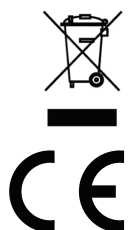

**Retrotouch, PO Box 1099, Worth, Crawley, RH10 OAD**  
**Tel: 01293 230407 Fax: 01293 471444 info@retrotouch.co.uk www.retrotouch.co.uk**