



## INSTALLATION WARNINGS:

### BEFORE COMMENCING INSTALLATION ISOLATE YOUR MAINS ELECTRIC SUPPLY

Read the instructions care fully before starting the installation process and keep them for future reference. This product must be installed by a qualified electrician. This product should be installed in accordance with the relevant sections of the building regulations code, and the current edition of the IEE Wiring Regulations (BS 7671: Requirements for electrical installations) and appropriate statutory regulations.

## Installation

**Remove the glass panel** of a touch remote switch: Using a small flat screwdriver remove the front cover by placing the screw driver in the location notch on the bottom part of the cover and twist to unclip the cover:

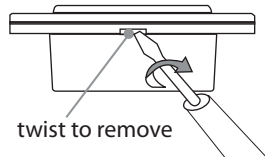

**Wiring:** Wire the wired switch as described in there instructions. remember to push wires firmly into terminals and tighten terminal screws so that wires are held securely. No bare wires should protrude from the terminals. Ensure correct wires are connect to the correct terminals, if incorrectly wired, this could damage the switch.

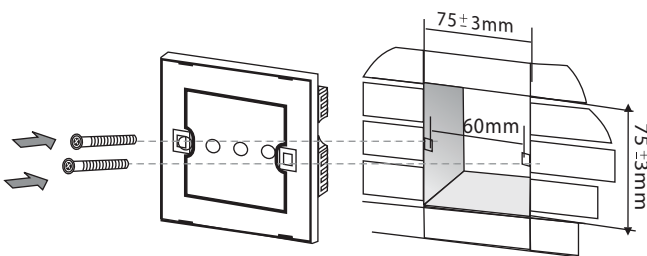

**Fix screws:** Use the screws supplied to attach switch to backbox using a flat head screwdriver

**Reattach the glass panel:** Align the glass panel over the switch and firmly push to click into place.

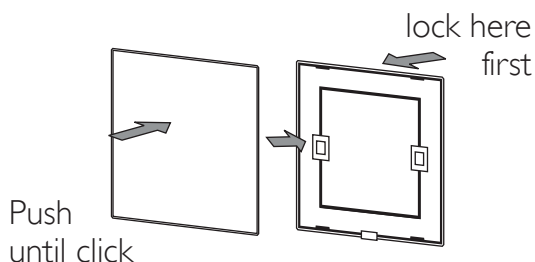

## WIRING:

### FOLLOW THE WIRING DIAGRAMS ON THE REVERSE

1. Only one switch should be connected to the Live
2. The Lamp can be connected to any lamp wire on the switch L1/L2/L3.
3. A/B must be connected with the A/B on the other switch.  
Be careful not to cross wires A must be linked to A and B linked to B.

## IMPORTANT:

### ONCE WIRED THE TWO SWITCHES MUST BE SYNCED TOGETHER TO WORK.

#### SYNCING THE SWITCHES:

**Step 1:** Press and hold one switch for 5 seconds until you hear a beep or see the blue backlight flashing

**Step 2:** The switches are in the registering state. Press the other switch when you see the blue backlight flashing the switches are synced to each other

*To unsync the switches press and hold any switch button for 10 seconds until you hear 2 beeps or the blue backlight flashes twice. Do not remove your hand when you hear the forst beep. Now all buttons will stop working until synced again.*

#### NOTES FOR INTERMEDIATE WIRING:

1. Each switch is capable of syncing to three switches
2. The Max load power should not exceed 1500W for all lights on the circuit.
3. The distance of the A/B can not exceed 30M
4. If the switch is not connected to the Light thier will be no beep
5. Remote controls are not compatible



## 2 WAY WIRING

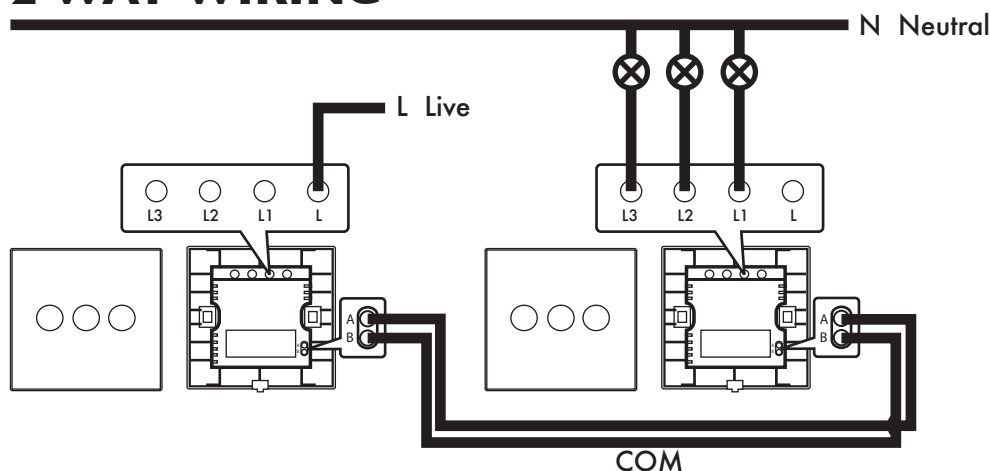

## INTERMEDIATE WIRING

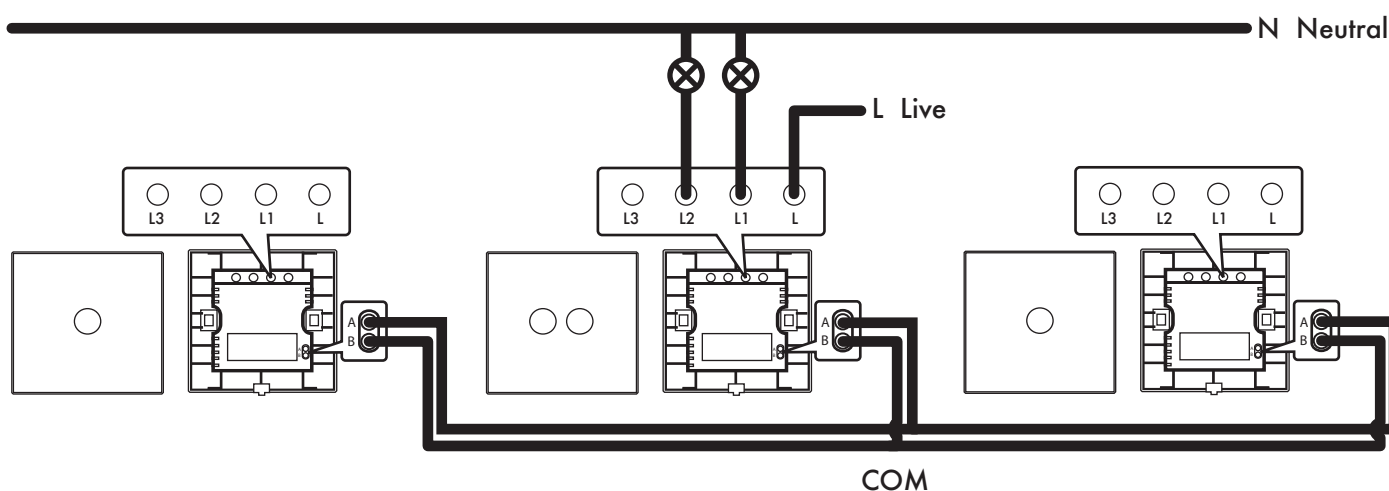

## Guarantee

All items purchased, come with a 1 year warranty (from date of purchase). Please keep proof of purchase.

If any of our products become faulty within this 1 year period, please contact us. Please send product/s by recorded post, as dispatch as we cannot be held liable for products lost in the post. If the product is found to be faulty, a replacement shall be working days from date received. In all cases, an identical replacement shall be sent, however, if the product has been discontinued a suitable alternative shall be sent with the same or similar specification.

